



PROVIDING THE BEST FOR LESS

1800 CABINS

1800 222 467

WWW.1800CABINS.AU

FAMILY 7 m x 8.5 m

Granny Flat / Cabin

3 Bedroom

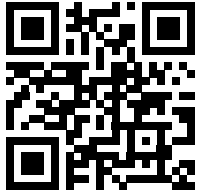

Width: 7 m

Length: 8.5 m

Area: 59.5 m²

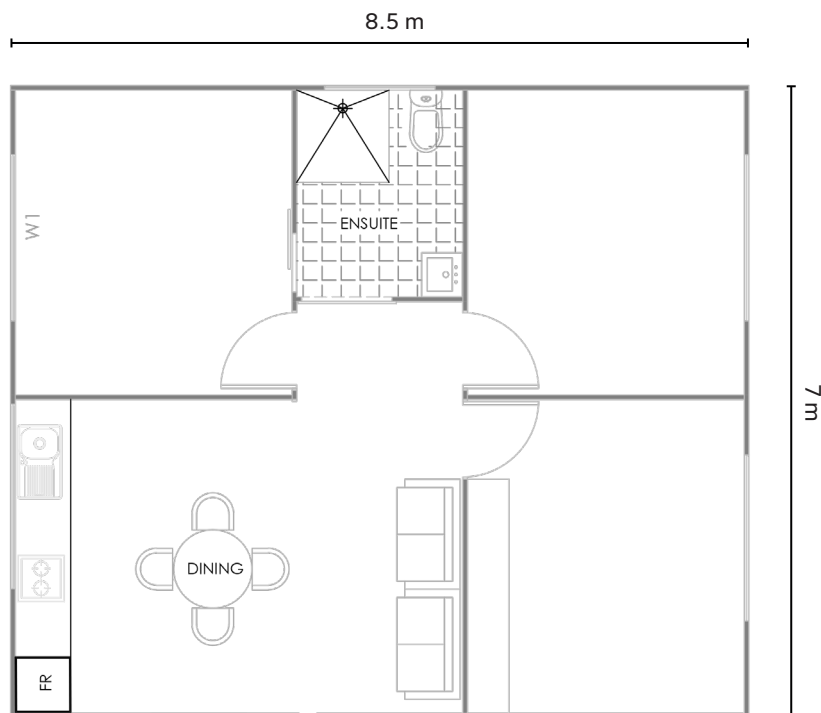

Showroom & Displays

376 Settlement Road, Thomastown VIC 3074

☎ 1800 222 467

✉ info@1800cabins.au

🌐 1800cabins.au

📷 1800Cabins.au

📘 1800Cabins.au

Mon – Fri: 9 am – 5 pm Sat: 9 am – 4 pm

Standard List of Inclusions – Family 7 m x 8.5 m Cabin

Bathroom

Double-glazed window, including security flyscreen (600 mm x 600 mm) [sizes optional]†

Dual-flush toilet*

Vanity (600 mm x 600 mm)

Bathroom overhead cupboard with mirror

Ceramic basin

Chrome/black basin mixer tap*

Shower unit (1000 mm x 1000 mm)*

Handheld showerhead*

Overhead shower dumper*

Isolating mixer tap*

Electric exhaust fan

2 x dual-port power points

LED lights

Choice of 3 different design commercial vinyl flooring [optional engineered/hybrid flooring].†

Bedroom 1 & Bedroom 2 & Bedroom 3

Double-glazed window, including security flyscreen (900 mm x 900 mm) [sizes optional]†

2 x dual-port power points

LED lights

Choice of 3 different design commercial vinyl flooring [optional engineered/hybrid flooring].†

External

External weatherproof sensor light

External 50 L hot water service [sizes optional]†

External guttering and down pipes

External weatherproof dual-port power points.

Options†

Outdoor decking†

Internal and external cladding†

Upgrade on appliances†

Upgrade on bathroom [tiling, shower screen, etc.]†

Aluminium frame frosted glass lockable internal door [options available]†

Plaster and paint, including skirting.†

Kitchen/Living

polytec laminate kitchen and joinery with overhead cupboards [L shaped or straight]

Electric induction cooktop

Slide-out electric rangehood fan

Kitchen sink*

Chrome/black kitchen sink mixer tap*

2 x dual-port power points

LED lights

Double-glazed sliding entrance door, including security flyscreen (2100 mm x 1800 mm) [sizes optional]†

Double-glazed window, including security flyscreen (900 mm x 900 mm) [sizes optional]†

Choice of 3 different design commercial vinyl flooring [optional engineered/hybrid flooring]†

Optional paint throughout.

Our Process

Our Turn-Key solution has been created for your convenience. We manage the process, from start to finish. Once you've chosen the right Granny Flat/Cabin for you, we'll initiate our streamlined process upon receiving a 10% deposit (this amount is fully refundable should a building permit not be obtained).

Step 1 – **10% deposit** → Creation of legal binding contract

Step 2 – Commencement of obtaining the building permit

Step 3 – **40% payment** → Completion of the Master Builders' contract & acquisition of building warranty insurance

Step 5 – Commencement of construction

Step 6 – **40% payment** → Delivery and installation of unit; connection of plumbing and electrical services via 15 amps external connection

Step 7 – Completion of construction

Step 8 – **10% final payment** → Issuance of Certificate of Occupancy.

*All appliances are WaterMark certified and meet all relevant Australian Standards.

†All options and add-ons are an extra cost for the customer and are not included in the standard list of inclusions.

All our panels are **Group 1 Bushfire Rated (BAL 40)**.

All our structure is constructed from **3 mm construction steel**.

Certified and engineered to meet up to **N4 Classification (wind speed up to 219 km/h)**.